



## MEMORANDUM

TO: Connie Kassian, Lumen  
Beau Townsend, Capital Electric Cooperative  
Doug Wiseman, MDU  
Bill Boyd, Randy Heaton  
Lance Bauer, Midcontinent Communications  
Derek Weigel, Midcontinent Communications  
USPS  
Steve Nelson, ND Department of Transportation  
Darin Scherr, Bismarck School District  
Office of the State Tax Commissioner  
Brady Blaskowski, Building Inspections  
Randy Ziegler, Police Department  
Allison Jensen, City Assessing  
Becky Fairbanks, City Assessing  
Gabe Schell, City Engineer  
Marcus Hall, County Engineer  
Tessa Knudson, County Auditor's Office  
Greg Carlson, County GIS  
Joel Boespflug, Fire Department  
Kelly Leben, Sheriff's Office  
Jami Wangler, GIS  
Darrel Nucech, GIS  
Jared Auch, GIS  
Audrey Reeb, Fire Department  
Cleary Johs, Engineering  
Soren Sanderson, Engineering  
Eric Lund, Finance  
Bernadette Houser, Public Works  
Will Hutchings, Planning  
Randy Bina, BPRD  
Kathy Feist, BPRD  
Dave Mayer, BPRD  
Wendy Anderson Berg, BPRD  
Tawny Wagner, Assessing

FROM: City Community Development Department ~ Planning Division

DATE: August 4, 2021

SUBJECT: Annexation

Please be advised that the following property has recently been annexed to the corporate limits of the City of Bismarck: Lots 2-4, Block 4; Lots 4-8, Block 5 and all adjoining rights-of-way,



Silver Ranch First Addition First Replat; and Lots 15-21, Block 2; Lots 1 and 8-12, Block 8; Lots 5-12 and 15-22, Block 9; and Lots 5-12, Block 10 and all adjoining rights-of-way, Silver Ranch First Addition.

The above annexation was approved by the Board of City Commissioners on July 26, 2021, and was recorded by the Recorder's Office on August 2, 2021.

If you have any questions or need any additional information on this request, please contact Daniel Nairn, the planner in our office assigned to this request, at 355-1854.



ORDINANCE NO. 6476

<i>First Reading</i>	<u>July 13, 2021</u>
<i>Second Reading</i>	<u>July 27, 2021</u>
<i>Final Passage and Adoption</i>	<u>July 27, 2021</u>

AN ORDINANCE ANNEXING PROPERTY TO THE CORPORATE LIMITS OF THE CITY OF BISMARCK, BURLEIGH COUNTY, NORTH DAKOTA, DECLARING THE TERRITORY ANNEXED; DECLARING THE SAME TO BE A PART OF THE CORPORATE LIMITS OF SAID CITY.

BE IT ORDAINED BY THE BOARD OF CITY COMMISSIONERS OF BISMARCK, BURLEIGH COUNTY, NORTH DAKOTA:

Section 1. Territory Annexed. The territory and land hereinafter described is hereby declared and found to be a part of the corporate limits of the City of Bismarck, North Dakota, as follows:

Lots 2-4, Block 4; Lots 4-8, Block 5 and all adjoining rights-of-way, Silver Ranch First Addition First Replat; and Lots 15-21, Block 2; Lots 1 and 8-12, Block 8; Lots 5-12 and 15-22, Block 9; and Lots 5-12, Block 10 and all adjoining rights-of-way, Silver Ranch First Addition, Burleigh County, North Dakota

The above described tract of land contains 15.04 acres, more or less.

Section 2. Provisions Applicable. From and after the final passage and adoption of this ordinance and upon recording of this ordinance with the Burleigh County Recorder, the territory herein described shall be a part of the corporate limits of the City of Bismarck, North Dakota.



**928589**

\$20.00  
Page: 2 of 3  
8/2/2021 1:51 PM  
Burleigh County

STATE OF NORTH DAKOTA     )  
  )  
COUNTY OF BURLEIGH     )

I, Jason Tomanek, do hereby certify that I am the duly appointed, qualified Assistant City Administrator of the City of Bismarck, North Dakota and that the foregoing is a full, true and correct copy of an ordinance adopted by the Board of City Commissioners at its regular meeting of July 27, 2021.

IN WITNESS WHEREOF, I have hereunto set my hand and the seal of the City of Bismarck, North Dakota, this 26<sup>th</sup> day of July, 2021.

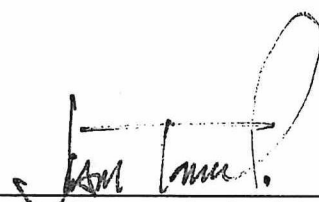

  
\_\_\_\_\_  
Jason Tomanek, Assistant City Administrator



# Location Map

ANNX2021-007

PT SILVER RANCH 1ST ADD. & SILVER RANCH 1ST ADD. 1ST REPLAT

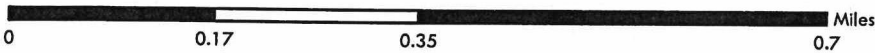
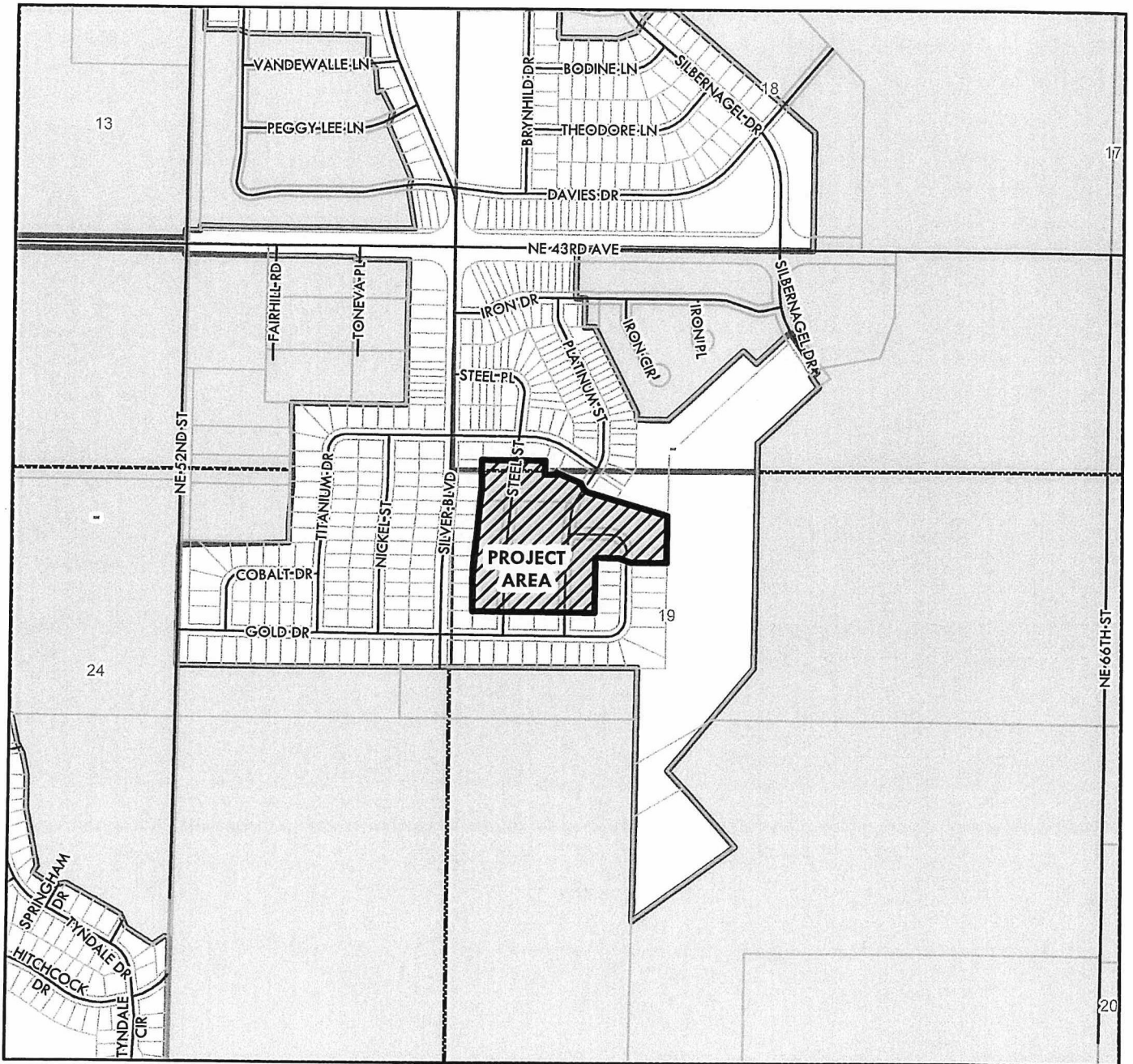

- City Limits
- Bismarck ETA Jurisdiction

County Outside ETA

*Section, township, and range indicated in orange*

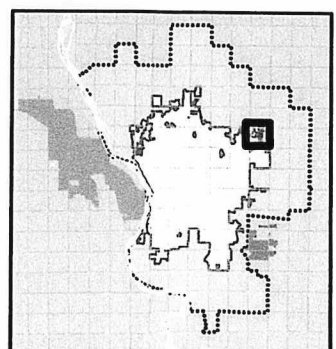

City of Bismarck  
 Community Development Department  
 Planning Division  
 May 28, 2021 (HLB)

*This map is for representational use only and does not represent a survey. No liability is assumed as to the accuracy of the data delineated herein.*