



## Community Development Department

### MEMORANDUM

TO: Connie Kassian, CenturyLink  
Mike Berg, Capital Electric Cooperative  
Doug Wiseman, MDU  
Bill Boyd, Midcontinent Communications  
Dennis Kuntz, USPS  
Steve Nelson, ND Department of Transportation  
Darin Scherr, Bismarck School District  
Office of the State Tax Commissioner  
Brady Blaskowski, Building Inspections  
Randy Ziegler, Police Department  
Allison Jensen, City Assessing  
Becky Fairbanks, City Assessing  
Gabe Schell, City Engineer  
Marcus Hall, County Engineer  
Tessa Knudson, County Auditor's Office  
Greg Carlson, County GIS  
Joel Boespflug, Fire Department  
Kelly Leben, Sheriff's Office  
Jami Wangler, GIS  
Darrel Nucech, GIS  
Jared Auch, GIS  
Audrey Reeb, Fire Department  
Cleary Johs, Engineering  
Jennifer Scheet, Finance  
Bernadette Houser, Public Works  
Will Hutchings, Planning  
Patty Rath, Fire  
Randy Bina, BPRD  
Kathy Feist, BPRD  
Dave Mayer, BPRD  
Wendy Anderson Berg, BPRD  
Tawny Wagner, Assessing

FROM: City Community Development Department ~ Planning Division

DATE: April 6, 2020

SUBJECT: Annexation

RECEIVED  
APR 13 2020  
TAX COMMISSIONER



Please be advised that the following property has recently been annexed to the corporate limits of the City of Bismarck: Lots 24-33, Block 1; Lots 1-4 and 15-44, Block 2; Lots 1-2 and 9-12, Block 3; Lot 1, Block 4; Lots 1-3, Block 5, Lots 1-21, Block 6, Silver Ranch First Addition First Replat and all of the adjacent 43rd Avenue NE right-of-way.

The above annexation was approved by the Board of City Commissioners on March 24, 2020 and was recorded by the Recorder's Office on April 2, 2020.

If you have any questions or need any additional information on this request, please contact Daniel Nairn, the planner in our office assigned to this request, at 355-1854.

ORDINANCE NO. 6416

<i>First Reading</i>	<u>March 10, 2020</u>
<i>Second Reading</i>	<u>March 24, 2020</u>
<i>Final Passage and Adoption</i>	<u>March 24, 2020</u>

AN ORDINANCE ANNEXING PROPERTY TO THE CORPORATE LIMITS OF THE CITY OF BISMARCK, NORTH DAKOTA, DECLARING THE TERRITORY ANNEXED; DECLARING THE SAME TO BE A PART OF THE CORPORATE LIMITS OF SAID CITY.

BE IT ORDAINED BY THE BOARD OF CITY COMMISSIONERS OF THE CITY OF BISMARCK, NORTH DAKOTA.

Section 1. Territory Annexed. The territory and land hereinafter described is hereby declared and found to be a part of the corporate limits of the City of Bismarck, <sup>(3)</sup>Burleigh County North Dakota, as follows:

Lots 24-33, Block 1; Lots 1-4 and 15-44, Block 2; Lots 1-2 and 9-12, Block 3; Lot 1, Block 4; Lots 1-3, Block 5; Lots 1-21, Block 6, and all adjacent right-of-way, all within Silver Ranch First Addition First Replat, and the North half of the adjacent 43rd Avenue NE right-of-way, more precisely described as the East 471.61 feet of the West 2,194.70 feet of the South 75 feet of the SW ¼ of Section 18, T139N-R79W/Gibbs Township, included in Document# 845385.

The above described tract of land contains 19.34 acres, more or less.

Section 2. Provisions Applicable. From and after the final passage and adoption of this Ordinance and upon recording of this ordinance with the Burleigh County Recorder, the territory herein described shall be a part of the corporate limits of the City of Bismarck, North Dakota.

STATE OF NORTH DAKOTA    )  
  )  
COUNTY OF BURLEIGH     )

I, Jason Tomanek, do hereby certify that I am the duly appointed, qualified Assistant City Administrator of the City of Bismarck, North Dakota and that the foregoing is a full, true and correct copy of an ordinance adopted by the Board of City Commissioners at its regular meeting of March 24, 2020.

IN WITNESS WHEREOF, I have hereunto set my hand and the seal of the City of Bismarck, North Dakota, this 24<sup>th</sup> day of March, 2020.

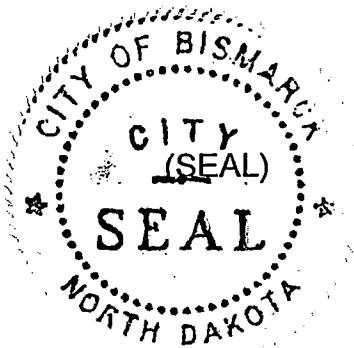

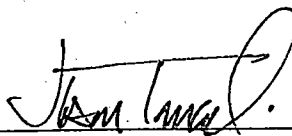
  
\_\_\_\_\_  
Jason Tomanek, Assistant City Administrator

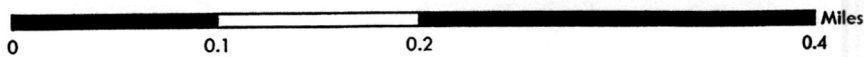
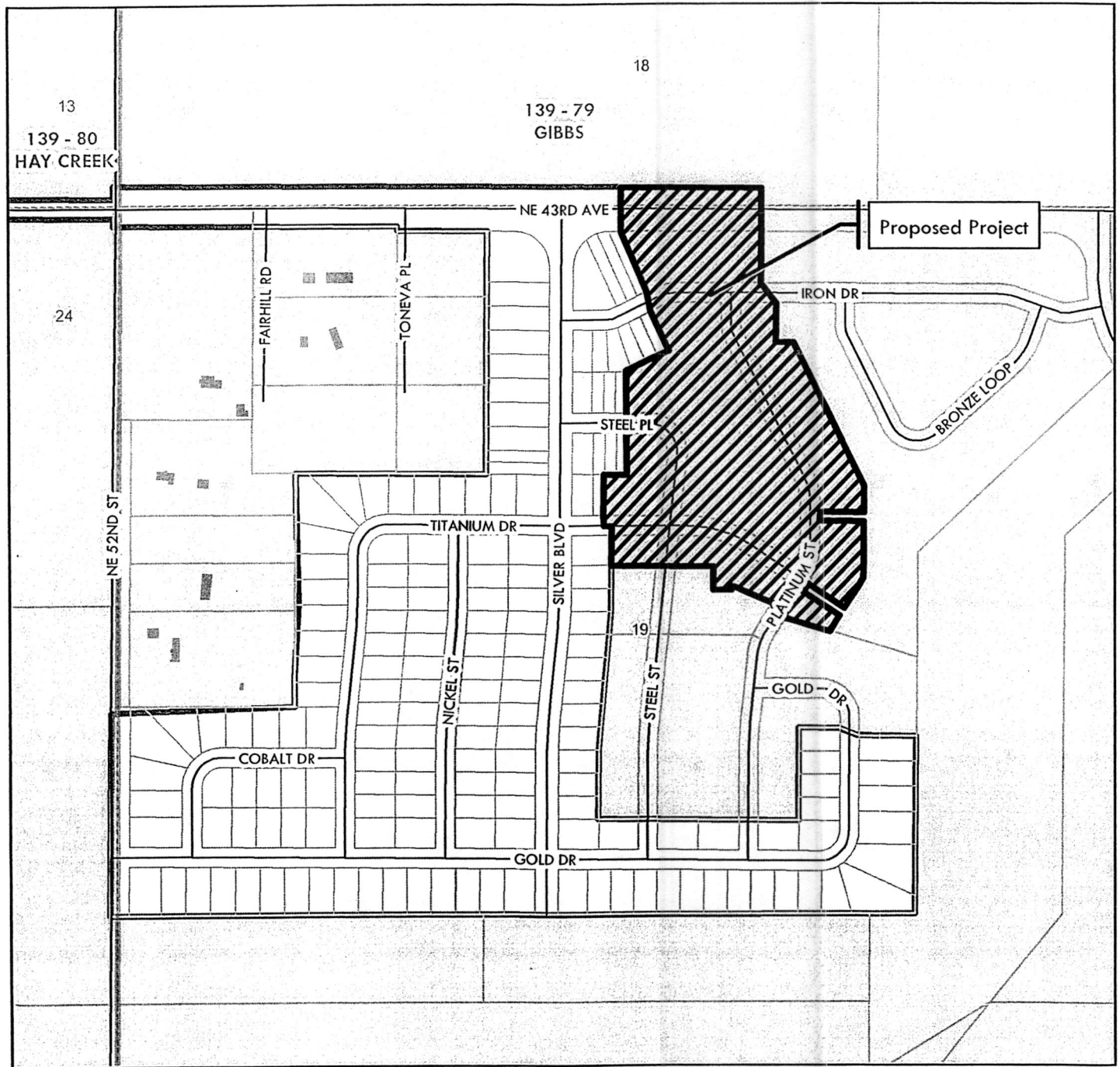

City Limits
  Bismarck ETA Jurisdiction  
 County Outside ETA

Section, township, and range indicated in orange

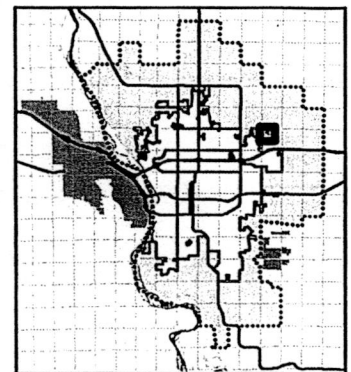

City of Bismarck  
 Community Development Department  
 Planning Division  
 January 30, 2020 (HLB)

*This map is for representational use only and does not represent a survey. No liability is assumed as to the accuracy of the data delineated hereon.*