



RECEIVED

JUL 25 2019

TAX COMMISSIONER

Community Development Department

MEMORANDUM

TO: Connie Kassian, CenturyLink
Mike Berg, Capital Electric Cooperative
Doug Wiseman, MDU
Bill Boyd, Midcontinent Communications
Dennis Kuntz, USPS
Steve Nelson, ND Department of Transportation
Darin Scherr, Bismarck School District
Susan Rood, Office of the State Tax Commissioner
Brady Blaskowski, Building Inspections
Randy Ziegler, Police Department
Allison Jensen, City Assessing
Becky Fairbanks, City Assessing
Gabe Schell, City Engineer
Marcus Hall, County Engineer
Tessa Knudson, County Auditor's Office
Greg Carlson, County GIS
Joel Boespflug, Fire Department
Kelly Leben, Sheriff's Office
Jami Wangler, GIS
Darrel Nucech, GIS
Jared Auch, GIS
Audrey Reeb, Fire Department
North Dakota State Tax Department
Cleary Johs, Engineering
Jennifer Scheet, Finance
Bernadette Houser, Public Works
Will Hutchings, Planning
Patty Rath, Fire
Randy Bina, BPRD
Kathy Feist, BPRD
Dave Mayer, BPRD
Wendy Anderson Berg, BPRD
Tawny Wagner, Assessing

FROM: City Community Development Department ~ Planning Division

DATE: July 22, 2019

SUBJECT: Annexation



Please be advised that the following property has recently been annexed to the corporate limits of the City of Bismarck: Part of Lot A of Lot 4 (to be known as Lot 1A of Lot 4), Block 2, Spiritwood Estates Subdivision.

The above annexation was approved by the Board of City Commissioners on February 26, 2019, and was recorded by the Recorder's Office on July 19, 2019.

If you have any questions or need any additional information on this request, please contact Jenny Wollmuth, the planner in our office assigned to this request, at 355-1845.

ORDINANCE NO. 6364

<i>First Reading</i>	<u>February 12, 2019</u>
<i>Second Reading</i>	<u>February 26, 2019</u>
<i>Final Passage and Adoption</i>	<u>February 26, 2019</u>
<i>Publication Date</i>	<u>February 16th & 23, 2019</u>

AN ORDINANCE ANNEXING PROPERTY TO THE CORPORATE LIMITS OF THE CITY OF BISMARCK, NORTH DAKOTA, DECLARING THE TERRITORY ANNEXED; DECLARING THE SAME TO BE A PART OF THE CORPORATE LIMITS OF SAID CITY.

BE IT ORDAINED BY THE BOARD OF CITY COMMISSIONERS OF THE CITY OF BISMARCK, NORTH DAKOTA.

Section 1. Territory Annexed. The territory and land hereinafter described is hereby declared and found to be a part of the corporate limits of the City of Bismarck, ^{Burleigh County} North Dakota, as follows:

Part of Lot A of Lot 4 (to be known as Lot 1A of Lot 4), Block 2, Spiritwood Estates Subdivision.

The above described tract of land contains .089 acres, more or less.

Section 2. Provisions Applicable. From and after the final passage and adoption of this Ordinance and upon recording of this ordinance with the Burleigh County Recorder, the territory herein described shall be a part of the corporate limits of the City of Bismarck, North Dakota.

STATE OF NORTH DAKOTA)
)
COUNTY OF BURLEIGH)

I, Jason Tomanek, do hereby certify that I am the duly appointed, qualified Assistant City Administrator of the City of Bismarck, North Dakota and that the foregoing is a full, true and correct copy of an ordinance adopted by the Board of City Commissioners at its regular meeting of February 26, 2019.

IN WITNESS WHEREOF, I have hereunto set my hand and the seal of the City of Bismarck, North Dakota, this 27th day of February, 2019.





Jason Tomanek, Assistant City Administrator

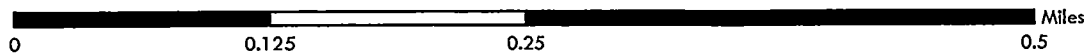
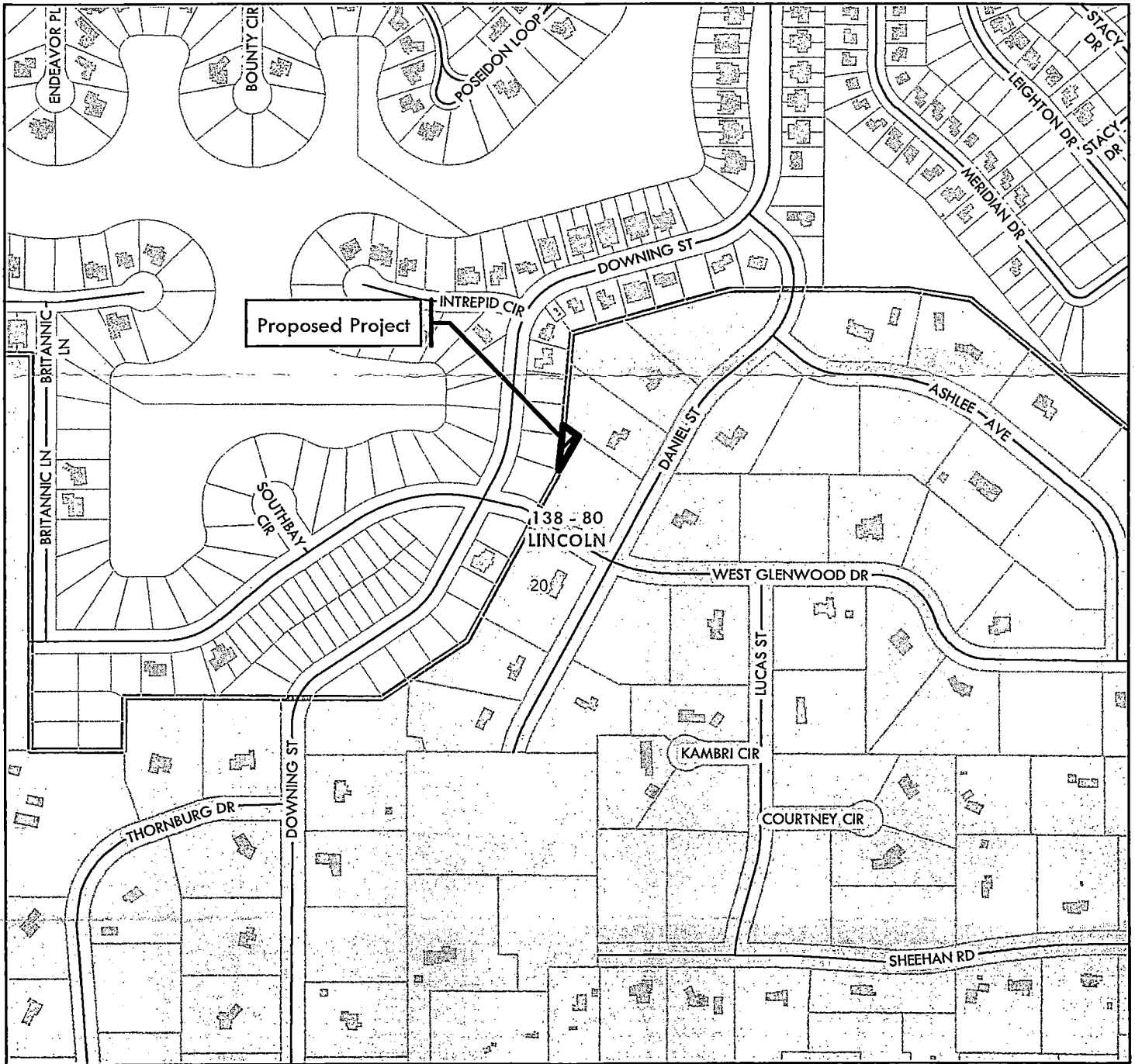

City Limits Bismarck ETA Jurisdiction

Section, township, and range indicated in orange



City of Bismarck
Community Development Department
Planning Division
December 6, 2018 (HLB)

This map is for representational use only and does not represent a survey. No liability is assumed as to the accuracy of the data delineated hereon.

