

ORDINANCE NO. 6290

|                                   |                                  |
|-----------------------------------|----------------------------------|
| <i>First Reading</i>              | <u>October 24, 2017</u>          |
| <i>Second Reading</i>             | <u>November 14, 2017</u>         |
| <i>Final Passage and Adoption</i> | <u>November 14, 2017</u>         |
| <i>Publication Date</i>           | <u>October 13 &amp; 20, 2017</u> |

AN ORDINANCE ANNEXING PROPERTY TO THE CORPORATE LIMITS OF THE CITY OF BISMARCK, NORTH DAKOTA, DECLARING THE TERRITORY ANNEXED; DECLARING THE SAME TO BE A PART OF THE CORPORATE LIMITS OF SAID CITY.

BE IT ORDAINED BY THE BOARD OF CITY COMMISSIONERS OF THE CITY OF BISMARCK, NORTH DAKOTA.

Section 1. Territory Annexed. The territory and land hereinafter described is hereby declared and found to be a part of the corporate limits of the City of Bismarck, North Dakota, as follows:

Lots 1-3, Block 1 and Lot 1, Block 2, Daybreak Medical Addition.

The above described tract of land contains 38.57 acres, more or less.

Section 2. Provisions Applicable. From and after the final passage and adoption of this Ordinance and upon recording of this ordinance with the Burleigh County Recorder, the territory herein described shall be a part of the corporate limits of the City of Bismarck, North Dakota.



**869402**

\$30.00  
Page: 1 of 3  
3/14/2018 11:24 AM  
Burleigh County

# Bismarck City Administration

CITY OF BISMARCK PLANNING ORDIN

**869402**  
\$30.00  
Page: 2 of 3  
3/14/2018 11:24 AM  
Burleigh County

STATE OF NORTH DAKOTA     )  
  )  
COUNTY OF BURLEIGH        )

I, Jason Tomanek, do hereby certify that I am the duly appointed, qualified Assistant City Administrator of the City of Bismarck, North Dakota and that the foregoing is a full, true and correct copy of an ordinance adopted by the Board of City Commissioners at its regular meeting of November 14, 2017.

IN WITNESS WHEREOF, I have hereunto set my hand and the seal of the City of Bismarck, North Dakota, this 15th day of November, 2017.



Jason Tomanek, Assistant City Administrator





**Proposed Major Plat, Annexation, Future Land Use Plan Amendment and Zoning Change (A to Conditional RT and Conditional CA)  
Daybreak Medical Addition**

Project  
Location Map

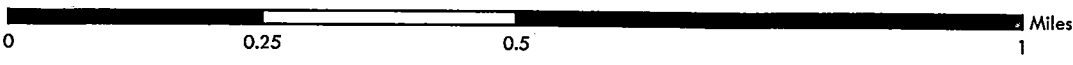
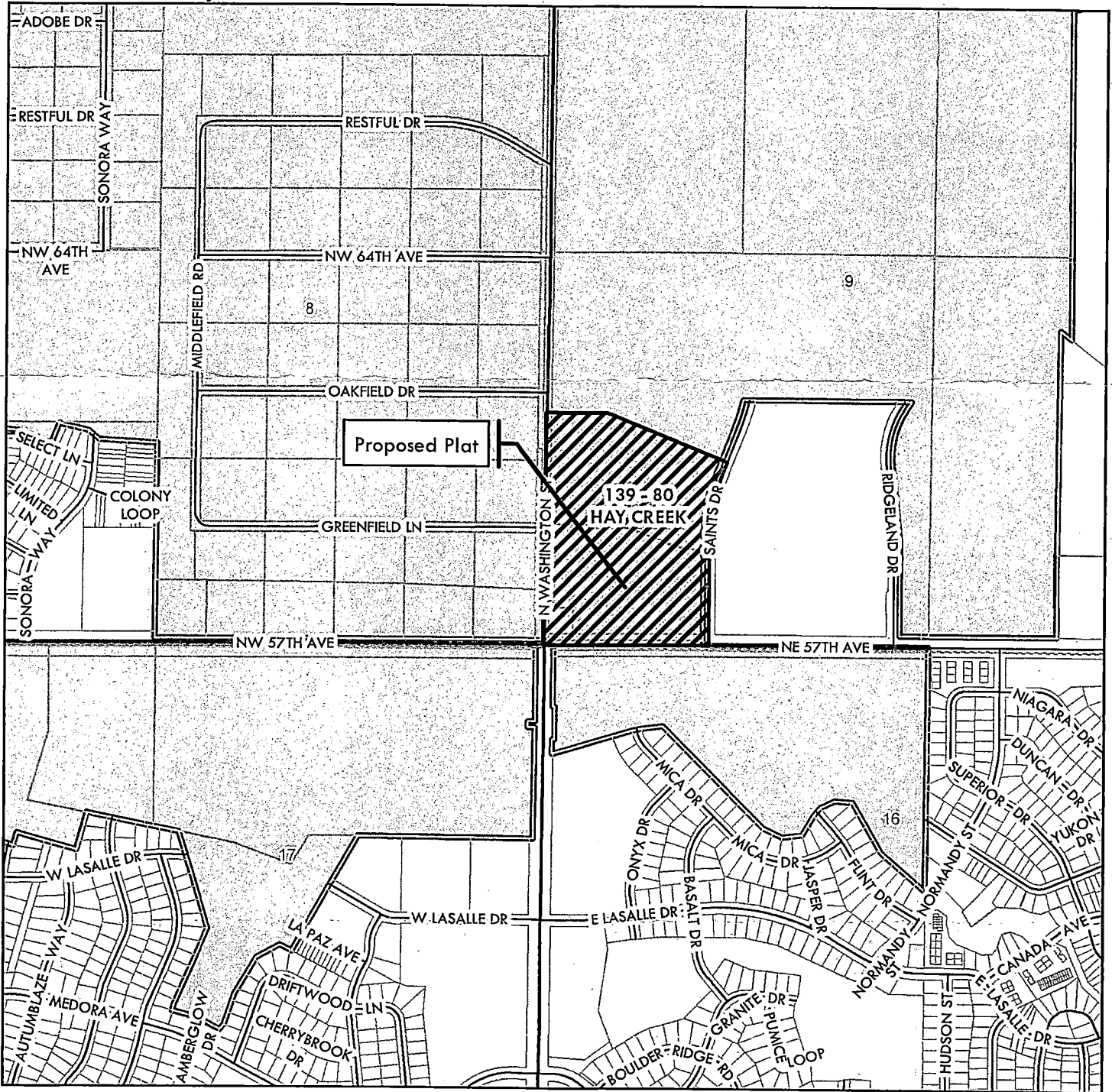

City Limits    Bismarck ETA Jurisdiction

Section, township, and range indicated in orange

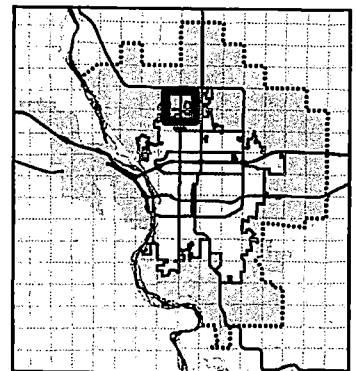

City of Bismarck  
Community Development Department  
Planning Division  
September 22, 2017 (HLB)

*This map is for representational use only and does not represent a survey. No liability is assumed as to the accuracy of the data delineated hereon.*